

UPDATE

May 2022

Minette Bay West Park

*Kitimat's First Waterfront
Public Recreational Space*

The District of Kitimat is excited to see the start of a new phase for Minette Bay West.

There are exciting things happening at Minette Bay West park, with upcoming work to install a causeway shelter at the waterfront, install picnic tables, and to complete a trail loop.

In order to complete this work quickly and safely, **Minette Bay West park will be closed to the public beginning May 25, until June 30.** Even once re-open, activity may continue through the summer.

The District of Kitimat remains committed to the development of our community's first public waterfront access. Minette Bay West Park will be a world-class destination to launch kayaks, canoes, and paddle boards, go for a walk, or just enjoy the splendor of nature.

The park is situated in a setting that is rich in biodiversity and provides natural opportunity for residents and visitors to experience the natural wonder of Kitimat.



KITIMAT
A Marvel of Nature and Industry

Take Advantage of the Natural Opportunity at Minette Bay West Park

Minette Bay West Park provides access to the authentic BC coast. Grab lunch from a local shop in Kitimat and bring it to picnic on the shore. Walk the surrounding trails and watch for eagles overhead.

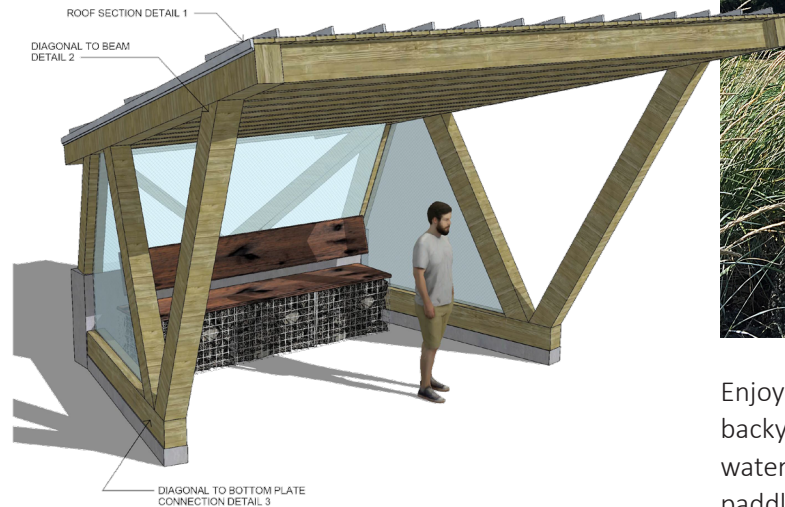

Rendering of causeway shelter design



Enjoy the natural biodiversity right in your own backyard. In the summer time, dip your toes in the water or go for a swim. Bring your kayak, canoe, or paddleboard to launch from the causeway. The Kitimat Chamber of Commerce even has paddle boards for rent! Use caution when accessing the water and shoreline as the area can be wet, slippery, and boggy with deep mud.

Project Timeline

